

TOP 9

**6.50(.256)
CENTERS**

**4.00(.157)
PLUNGER TRAVEL**

Dimensions in mm (inches)

TECHNICAL DATAS

Minimum centers	6.50 mm (.256)
Full travel	4.00 mm (.157)
Rated stroke	3.00 mm (.118)
Probe resistance	< 30 MOhm
Operating temperature	-55°C/ +105°C (-67°F/+221°F)
Current rating	5 AMP

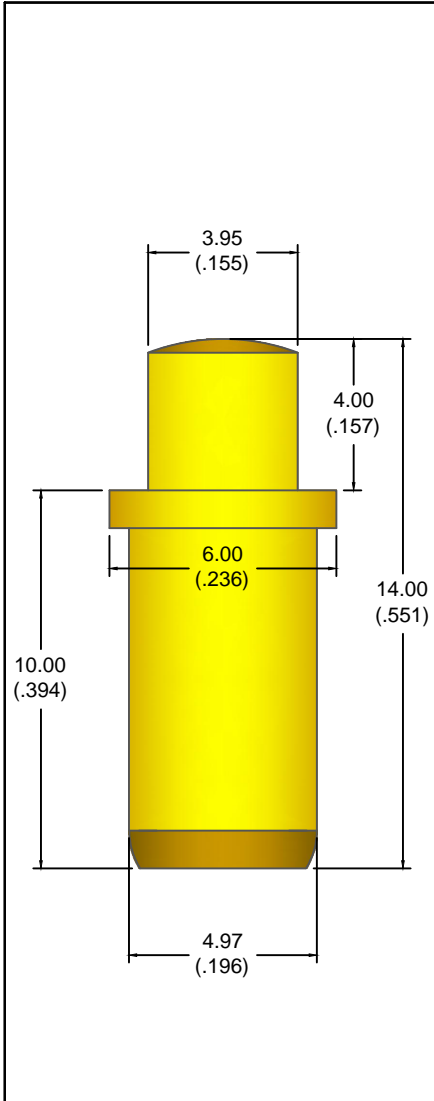

MATERIALS AND FINISHES

Plunger	Copper alloy, gold plated
Barrel	Copper alloy, gold plated
Spring	Music wire, gold plated

SPRING FORCE IN GR. (OZ.)

PRELOAD	2/3 TRAVEL
40 (1.41)	100 (3.53)
60 (2.12)	150 (5.29)
130 (4.58)	300 (10.58)
155 (5.47)	400 (14.11)

Additional spring forces available. Please consult factory

RECEPTACLE SPECIFICATIONS

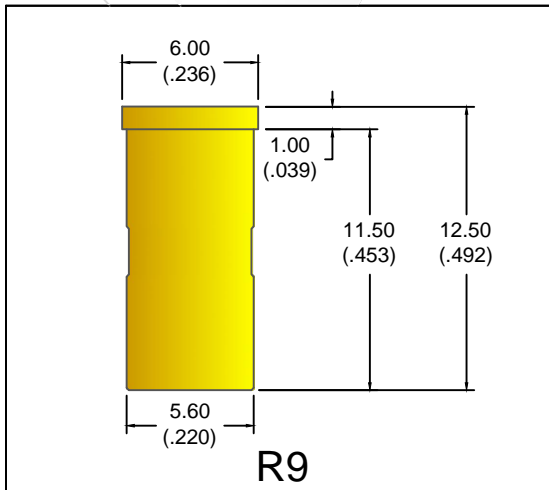

MOUNTING HOLE SIZE
5.70/5.90 (.224/.232)

MATERIALS AND FINISHES

BARREL	Copper alloy gold plated
--------	--------------------------

AVAILABLE HEAD STYLES

Head style	Available diametres	Head style	Available diametres	Head style	Available diametres
	3.95(.155)				
				NOTES MATERIALS S - STEEL L - COPPER ALLOY	



HOW TO ORDER

MODEL TOP 9	HEAD C	HEAD DIA 3.95	SPRING FORCE 2/3 TRAVEL 100	TREATMENT G
-----------------------	------------------	-------------------------	------------------------------------------	-----------------------